

Čapkova 22
CZ - 678 01 Blansko
tel.: +420 516 416942, 419995
fax: +420 516 416963

HEAD-TYPE RESISTANCE THERMOMETERS

Design:

- designed to be mounted in a pipeline or into a vessel wall
- the model includes a two-wire programmable converter 4-20mA

Resistance thermometer without converter:

The sensor holding stem is made of AISI321 stainless steel. The metal head (enclosure IP56) houses a terminal board. The lengths X and Y are customer defined. By arrangement, different mounting bolts are available, e.g., G3/4, M27x2, M20x1.5... Pt100/A or B, Pt1000, or possibly also Ni1000 in two or four-wire connection can be mounted. By arrangement, a double sensor can be mounted, too.

PM55 - for liquid, 6mm, -25...+400°C (t=ca 7sec)

Technical specifications:

- Temperature sensor: Pt100/"B" or "A", to ČSN IEC 751
- Ambient temperature: -25...+100°C
- Liquid pressure: max. 2.5 MPa
- Dielectric strength: 500V, insulation resistance: 20MΩ at least (circuit to metal casing)

Resistance thermometer with programmable converter 4-20mA:

The sensor holding stem is made of AISI321 stainless steel. The metal head (enclosure IP56) houses a PMA300 converter with a 4...20mA output. The lengths X and Y are customer defined. Different mounting bolts, e.g. G3/4, M27x2, M20x1.5...are available by arrangement. Customized measuring range of the converter is available; too, minimum temperature interval is 10°C. Sensor Pt100/A or B, Pt1000, Ni1000 can be mounted, to.

PMP55 - for liquid, 6mm, -25...+400°C (t=ca 7sec)

Technical specifications:

- Temperature sensor: Pt100/"B" or "A", to ČSN IEC 751, or other according to customer requirements
- Measuring range: arbitrary, within the permissible range, minimum temperature interval: 10°C
- Accuracy: ±0.3% of full scale deflection (max. ±0.25°C)
- Output: 4...20mA linearized
- Power supply: 8...30V DC, via output line
- Ambient temperature: -25...+80°C
- Liquid pressure: max. 15 MPa
- Dielectric strength: 500V, insulation resistance: 20MΩ at least (circuit to metal casing)

Thermometers marked as PM55H or PMP55H are without mounting screw. There is only length X defined.

The remaining parameters are given in the datasheet converter PMA300, which is used in device.

Conformity declaration:

- Basic type test -in compliance with ČSN EN 60751
- EMC: -in compliance with ČSN EN 61326-1
- Safety: -in compliance with ČSN EN 61010-1

Connection terminals:

+, - : output current loop 4-20mA

terminals for two, three or four wire connection

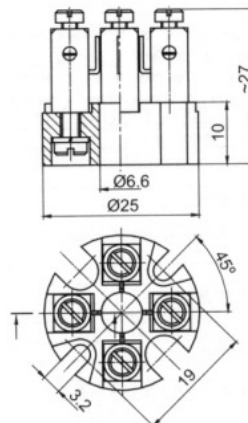
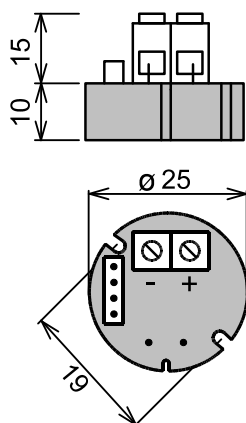

PM55 (PMP55)



The terminals accept wires with cross section 2.5 mm² max.

The order should include:

the design without transmitter:

- type of sensor, or other customs requirements (as four-tread connection, double sensor...)
- estimated maximum measured temperature
- total length of the stem (X) and draft (Y) see table bellow
- mounting screw - M12x1,5, G1/2....
- number of pieces

Table of the recommended distance from the screw head:

to 100°C.....	min.
125°C.....	50mm
150°C.....	80mm
200°C.....	100mm
300°C.....	120mm
400°C.....	160mm

the design with transmitter:

- type of sensor
- measuring range [°C]
- total length of the stem (X) and draft (Y) see table bellow
- mounting screw - M12x1,5, G1/2....
- number of pieces

Table of the recommended distance from the screw head:

to 80°C.....	min.
100°C.....	50mm
125°C.....	80mm
150°C.....	100mm
200°C.....	120mm
300°C.....	140mm
400°C.....	180mm

Examples of orders:

PM55 160/80mm G1/2 P100/B max. 150°C, 1pc
PMP55 300/160mm M20x1,5 0...+300°C, 10pc
PM55 min/100mm M12x1,5 2xPt1000/B max. 100°C, 3pc
The thermometers can be ordered exposure calibration protocol
We also installation and adjustment converters supplied by the heads of other thermometers manufacturers or refurbishing older equipment.

Dimensions:

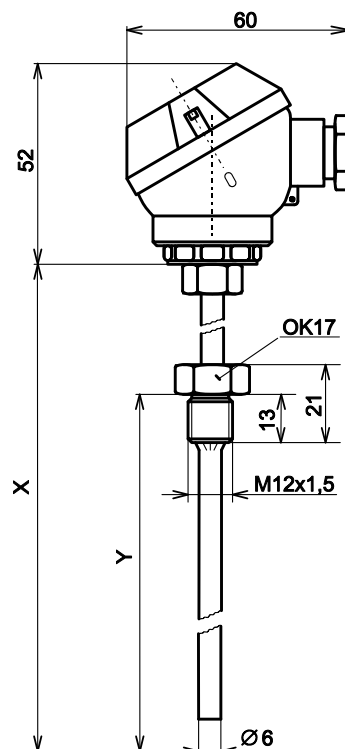

Disposal at the end of life to make a separate collection.
Rawet s.r.o. is the member of association RETELA www.retela.cz